



Figure 1. HDL-MPTC03.48



Figure 2. HDL-MPTC03.46

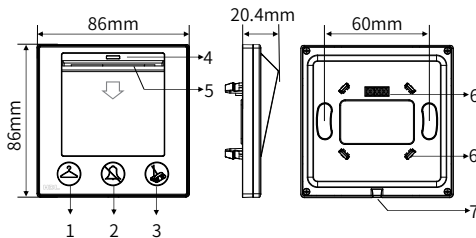

Figure 3

Figure 4

Figure 5

Figure 3 - 5. Dimensions

HDL-MPTC03.48

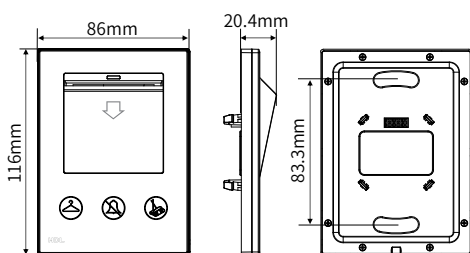

Figure 6

Figure 7

Figure 8

Figure 6 - 8. Dimensions

HDL-MPTC03.46

## Overview

RF Card Reader & Master Control EU(US) with 3 Service Buttons (See Figure 1-2) is for energy control and room information of hotel guest room. It has built-in MIFARE RF card reader. Guest card, service card, cleaner card, etc. can be recognized by this panel, and it includes 3 touch buttons also. Customer can select US or EU standard panel according to their requirements.

## Functions

- Master card for energy & power management.
- 3 touch buttons, sensitivity can be adjusted
- Button color RGB can be adjusted
- The touch button can be used as the panel button, or work with HDL touch door bell panel, can be displayed DND, Clean, Wait.
- Control of mechanical switch can be configured when inserting or taking off the card. Up to 49 targets can be controlled by the switch. Maximum 99 targets can be controlled by other button modes
- Support online update via HDL Buspro Setup Tool

## Important Notes

- The card reader should be used in conjunction with the power interface.
- Buspro cable - CAT5E or dedicated HDL Buspro cable.
- Buspro connection - Series connection (hand-in-hand recommended).
- Installation - EU wall box, installed near the guest room door.

## Product Information

### Product dimensions - See Figure 3 - 8

Button 1, 2 and 3 stand for touch buttons, and their controlled targets can be configured via software offline.

4.Indicator: After power on, it turns red. It turns green after inserting the card

5.Card slot

6. Communication interface and fastener: Connect to panel power interface

7. Split gap: Insert the slotted screw driver to the split gap, and separate the panel and power module

### Note

This device can work with HDL touch door bell, when control 3 touch buttons (DND, Clean Room, Laundry), the touch door bell status will be displayed, and also can control other targets at the same time.

**Card:** The new cards have to be assigned by the hotel guest room management software. There are totally 5 types of cards: Guest card, waiter card, cleaner card, mender card, manager card. When you use different cards, you can control different target scenes.

## Safety Precautions

- The installation and testing for the product must be carried out by HDL Automation Co., Ltd. or its appointed service agencies. The electric construction shall comply with local laws and safety regulations.
- The device should be installed in wall box. HDL will not be responsible for any consequence caused by the inexpert or faulty installation and wiring methods, which are not in accordance with the instructions contained in this operating instruction.
- Please do not privately disassemble or replace any parts of the product. Otherwise, it may cause mechanical fault, electric shock, fire or personal injuries.
- Please contact our after-sales departments or our designated service agencies for your maintenance service. Product failures caused by private disassembly are not subject to this warranty.

## Package Contents

HDL-MPTC03.48 or HDL-MPTC03.46\*1 / IC card\*1 / Datasheet\*1

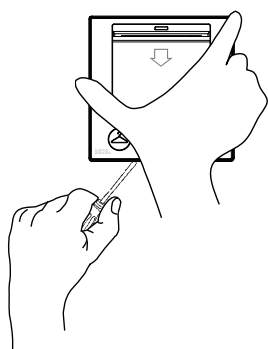
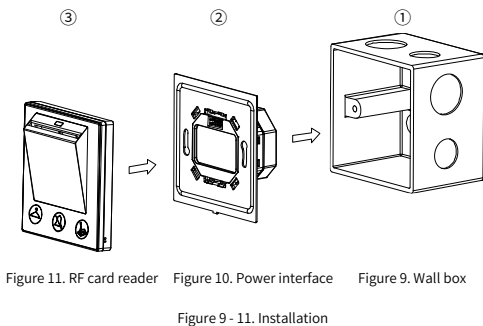

## Technical Data

### Basic Parameters

Working voltage	12~30V DC
Working current	60mA/24V DC
Supported card type	MIFARE ONE S50 13.56MHz
Communication	HDL Buspro

### External Environment

Working temperature	-5°C~45°C
Working relative humidity	≤90%
Storage temperature	-20°C~60°C
Storage relative humidity	≤93%

### Specifications

Dimensions	86×86×20.4 (mm) (EU) 116×86×20.4 (mm) (US)
Net weight	EU: 107g US: 330g
Housing material	Glass, ABS
Installation	Wall box (See Figure 9-11)
Protection rating (Compliant with EN 60529)	IP20

### Approved

CE

## HDL Buspro Cable Guide

HDL Buspro	HDL Buspro Cable	CAT5/CAT5E
DATA+	Yellow	Blue/Green
DATA-	White	Blue white/Green white
COM	Black	Brown white/Orange white
24V DC	Red	Brown/Orange

## Installation

### Product installation and disassembly

Take HDL-MPTC03.48 as an example

#### Installation - See Figure 9 - 11

Step ①: Install the wall box in the wall.

Step ②: Fix the power interface onto the wall box with screws.

Step ③: Hold the edge of the panel, and insert the panel in the slots of power interface vertically.

#### Disassembly - See Figure 12

Step ①: Insert a straight screwdriver into the gap between the panel and power interface.

Step ②: Hold the panel, pry up the panel gently and take down the panel.

#### Technical support

E-mail: [hdltickets@hdlautomation.com](mailto:hdltickets@hdlautomation.com)

Website: <https://www.hdlautomation.com>

©Copyright by HDL Automation Co., Ltd. All rights reserved.  
Specifications subject to change without notice.